

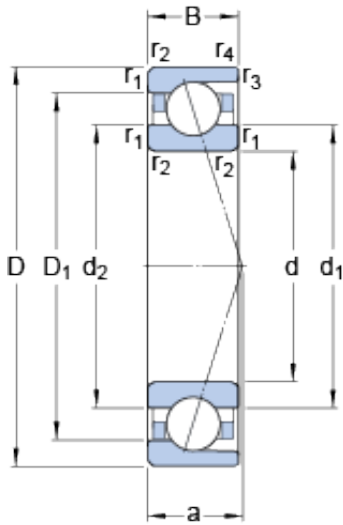

BEARING USA CORP.



35 mm x 62 mm x 14 mm SKF 7007 ACD/P4A Angular contact ball bearings

Bearing No. 7007 ACD/P4A

7007 ACD/P4A Bearing 2D drawings and 3D CAD models

Size	62x35x14 mm
Bore Diameter	62 mm
Outer Diameter	35 mm
Width	14 mm
d	35 mm
D	62 mm
B	14 mm
d ₁	43.7 mm
d ₂	43.7 mm
D ₁	53.3 mm
r _{1,2} - min.	1 mm
r _{3,4} - min.	0.3 mm
a	18.5 mm
d _a - min.	39.6 mm
d _b - min.	39.6 mm
D _a - max.	57.4 mm
D _b - max.	60 mm
r _a - max.	1 mm
r _b - max.	0.3 mm
d _n	45.3 mm
Basic dynamic load rating - C	14.8 kN
Basic static load rating - C ₀	9 kN
Fatigue load limit - P _u	0.38 kN
Limiting speed for grease	20000 r/min



BEARING USA CORP.

Lubrication	
Limiting speed for oil lubrication	32000 mm/min
Ball - D_w	7.938 mm
Ball - z	16
G_{ref}	1.98 cm ³
Calculation factor - e	0.68
Calculation factor - Y_2	0.87
Calculation factor - Y_0	0.38
Calculation factor - X_2	0.41
Calculation factor - Y_1	0.92
Calculation factor - Y_2	1.41
Calculation factor - Y_0	0.76
Calculation factor - X_2	0.67
Preload class A - G_A	90 N
Preload class B - G_B	180 N
Preload class C - G_C	360 N
Preload class D - G_D	720 N
Calculation factor - f	1.06
Calculation factor - f_1	0.99
Calculation factor - f_{2A}	1
Calculation factor - f_{2B}	1.02
Calculation factor - f_{2C}	1.05
Calculation factor - f_{2D}	1.08
Calculation factor - f_{HC}	1
Preload class A	86 N/micron
Preload class B	110 N/micron
Preload class C	144 N/micron
Preload class D	190 N/micron



BEARING USA CORP.

Category	Precision Ball Bearings
Inventory	0.0
Manufacturer Name	SKF
Minimum Buy Quantity	N/A
Weight / Kilogram	0.162
EAN	7316570430851
Product Group	B04270
Enclosure	Open
Precision Class	ABEC 7 ISO P4
Material - Ball	Steel
Number of Bearings	1 (Single)
Contact Angle	25 Degree
Preload	None
Raceway Style	1 Rib Outer Ring
Cage Material	Phenolic
Rolling Element	Ball Bearing
Flush Ground	No
Inch - Metric	Metric
Other Features	Single Row Angular Contact High Precision
Long Description	35MM Bore; 62MM Outside Diameter; 14MM Width; Open Enclosure; ABEC 7 ISO P4 Precision; Steel Ball Material; 1 (Single) Bearings; 25 Degree Contact Angle; Phenolic Cage Material; 1 Rib Outer Ring Rac
Category	Precision Ball Bearings
UNSPSC	31171531
Harmonized Tariff Code	8482.10.50.28
Noun	Bearing
Keyword String	Angular Contact Ball
Manufacturer URL	http://www.skf.com



BEARING USA CORP.

Manufacturer Item Number	7007 ACD/P4A
Weight / LBS	0.355
Width	0.551 Inch 14 Millimeter
Bore	1.378 Inch 35 Millimeter
Outside Diameter	2.441 Inch 62 Millimeter
d_1	43.7 mm
d_2	43.7 mm
D_1	53.3 mm
$r_{1,2}$ min.	1 mm
$r_{3,4}$ min.	0.3 mm
d_a min.	39.6 mm
d_b min.	39.6 mm
D_a max.	57.4 mm
D_b max.	60 mm
r_a max.	1 mm
r_b max.	0.3 mm
d_n	45.3 mm
Basic dynamic load rating C	14.8 kN
Basic static load rating C_0	9 kN
Fatigue load limit P_u	0.38 kN
Attainable speed for grease lubrication	20000 r/min
Attainable speed for oil-air lubrication	32000 r/min
Ball diameter D_w	7.938 mm
Number of balls z	16
Reference grease quantity G_{ref}	1.98 cm ³
Preload class A G_A	90 N
Static axial stiffness, preload class A	86 N/ μ m
Preload class B G_B	180 N
Static axial stiffness, preload class B	110 N/ μ m



BEARING USA CORP.

Preload class C G_C	360 N
Static axial stiffness, preload class C	144 N/ μ m
Preload class D G_D	720 N
Static axial stiffness, preload class D	190 N/ μ m
Calculation factor f	1.06
Calculation factor f_1	0.99
Calculation factor f_{2A}	1
Calculation factor f_{2B}	1.02
Calculation factor f_{2C}	1.05
Calculation factor f_{2D}	1.08
Calculation factor f_{HC}	1
Calculation factor e	0.68
Calculation factor (single, tandem) Y_2	0.87
Calculation factor (single, tandem) Y_0	0.38
Calculation factor (single, tandem) X_2	0.41
Calculation factor (back-to-back, face-to-face) Y_1	0.92
Calculation factor (back-to-back, face-to-face) Y_2	1.41
Calculation factor (back-to-back, face-to-face) Y_0	0.76
Calculation factor (back-to-back, face-to-face) X_2	0.67
Mass bearing	0.15 kg